

# KUDU™ Series Land Rover® Realistic Engine Bay Set (#BRX02378)

Difficulty Level: ★★☆☆☆

## INSTALLATION MANUAL

For best results, we recommend to paint everything first before gluing and assembly.

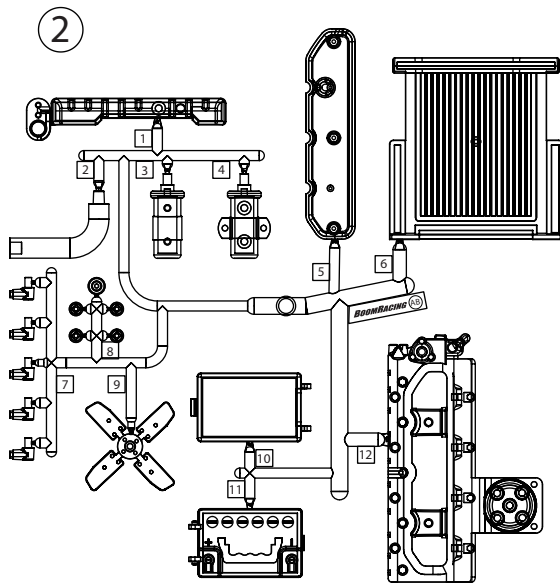
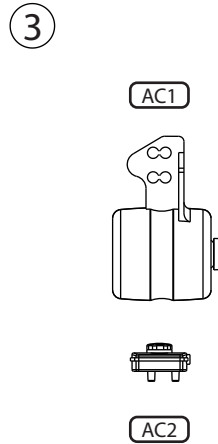
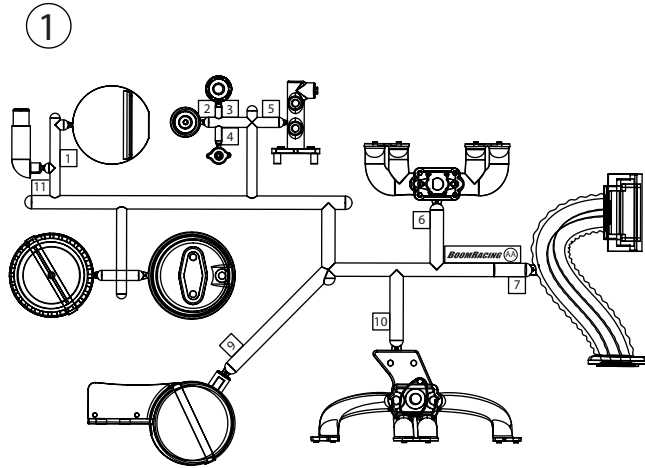

### Parts Included:

| Part                             | Qty. |
|----------------------------------|------|
| (1) Part Tree AA                 | 1    |
| (2) Part Tree AB                 | 1    |
| (3) Part Tree AC                 | 1    |
| (4) ST1.5x3 CS Screw             | 1    |
| (5) ST1.5x4 CCS Round Head Screw | 2    |
| (6) ST1.7x4 CCS Round Head Screw | 4    |
| (7) M3x6 RS Screw                | 2    |
| (8) M3x8 RS Screw                | 2    |
| (9) 1.2mm Drill Bit              | 1    |
| (10) Double Sided Tape           | 3    |
| (11) Syringe                     | 1    |
| (12) Suction Tube                | 1    |
| (13) Wires                       | 2    |
| (14) Flexible hose               | 1    |
| (15) Decals                      | 1    |

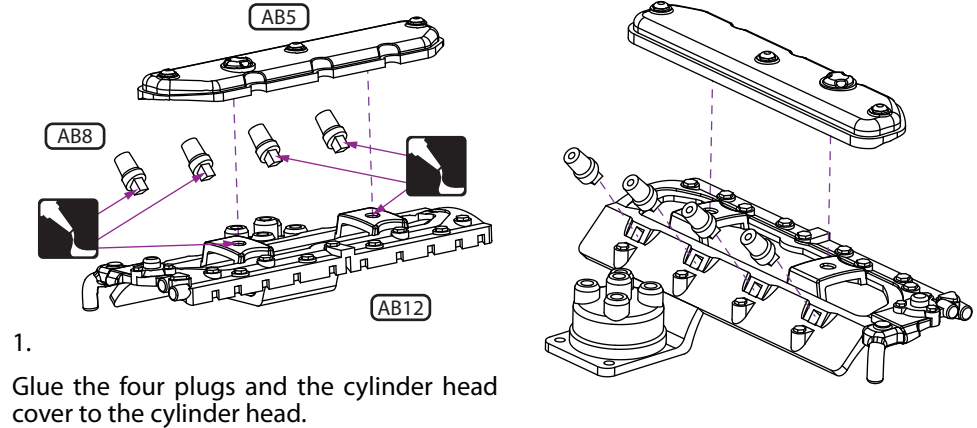

1. Glue the four plugs and the cylinder head cover to the cylinder head.

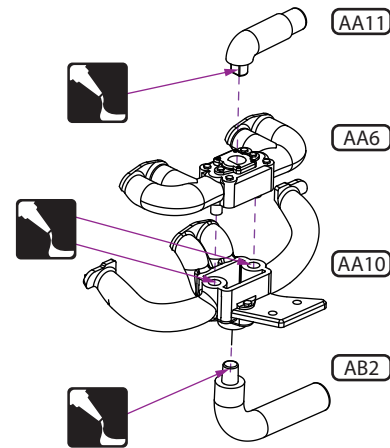

2. Glue the intake pipe to the intake manifold, then to the exhaust manifold, and finally to the down pipe.

3. Push the spark plug ends into the distributor (we advice not to glue these in).

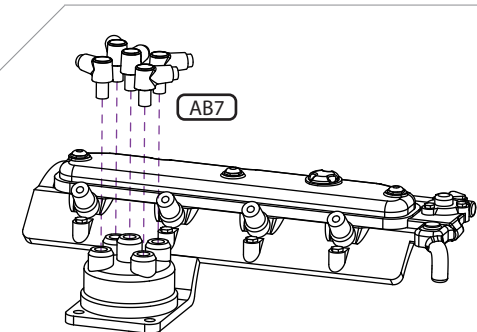

# KUDU™ Series Land Rover® Realistic Engine Bay Set (#BRX02378)

Difficulty Level: ★★☆☆☆

4.

Glue the manifold assembly to the cylinder head assembly. Make sure they sit flush together.

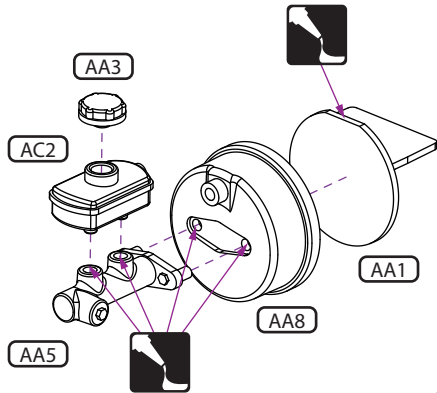
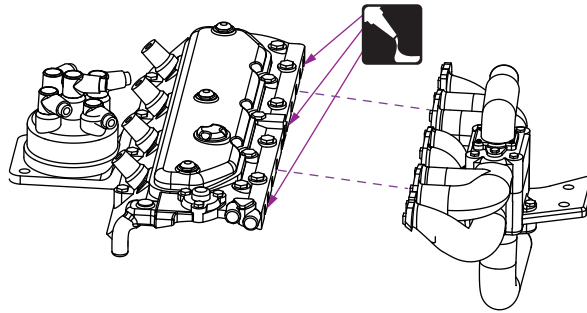

5.

Add liquid into the brake fluid tank and then push the cap on to seal it. Glue the tank onto the brake master cylinder and then to the vacuum booster pump and to the backing plate.

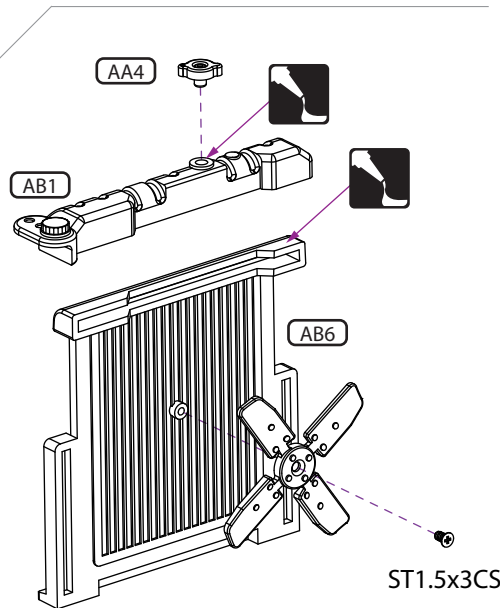

6.

Glue the radiator cap to the top half of the radiator and then to the bottom half of the radiator. Attach the fan to the radiator with a ST1.5x3 screw.

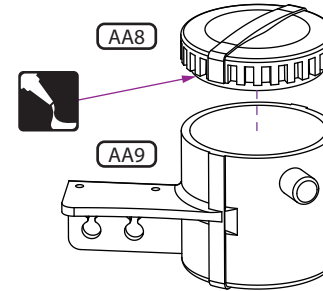

7.

Glue the air filter top to the air filter main body.



Caution: do not use corrosive liquid which might permanently damage the tank.

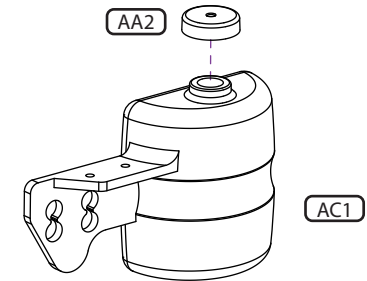

8.

You can add liquid into the washer fluid tank with the provided syringe and push the cap onto it to seal it.

9.

Glue the ignition coil halves together and push the coil lead end onto it.



For quick release purpose, do not glue this area.

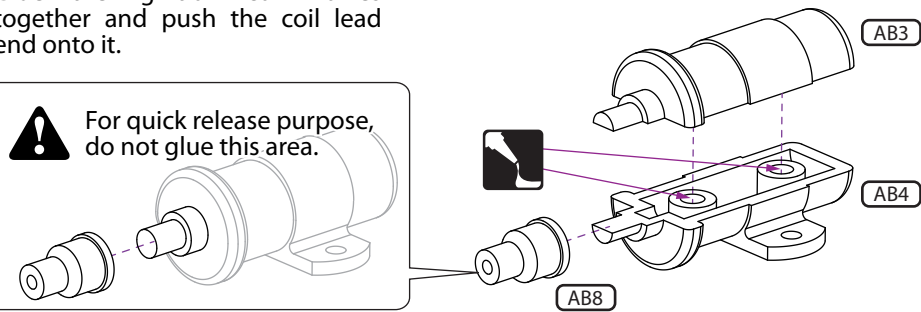

10.

Find the location you want to mount the ignition coil to the fire wall and drill two holes into the fire wall of the main body. Then attach it with two ST1.5x4CCS screws.

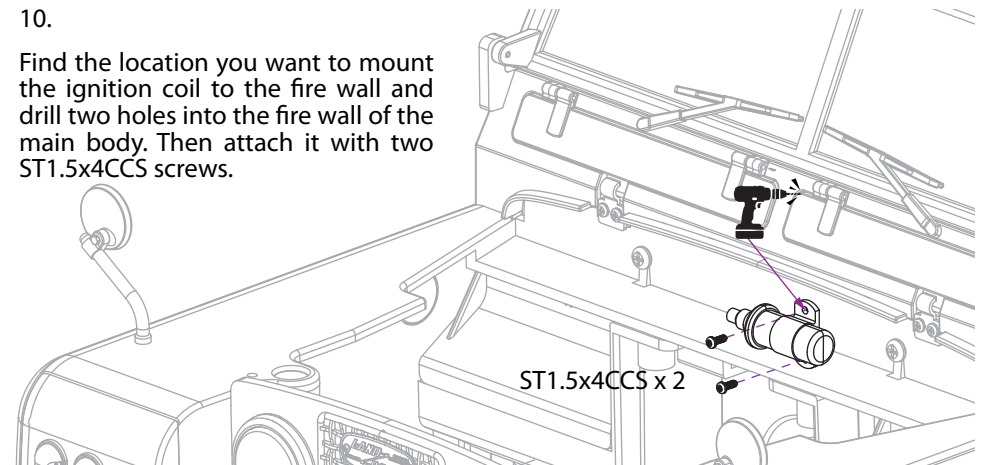

# KUDU™ Series Land Rover® Realistic Engine Bay Set (#BRX02378)

Difficulty Level: ★★☆☆☆

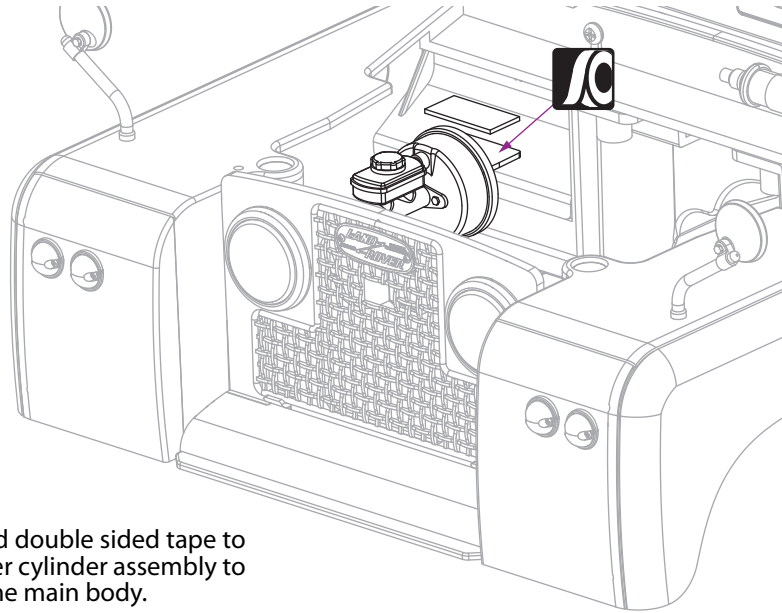

11.

Use the provided double sided tape to attach the master cylinder assembly to the fire wall of the main body.

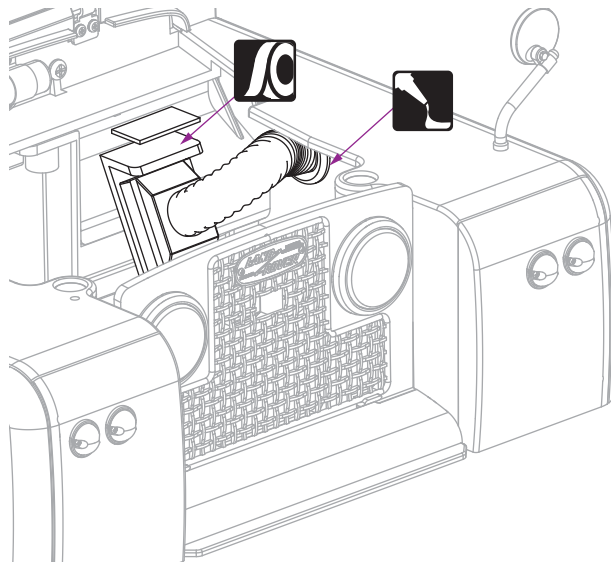

12.

Use the provided double sided tape to attach the heater matrix to the main body. Make sure the side intake hole is lined up with the pipe, then glue in place (like indicated on the diagram on the right).

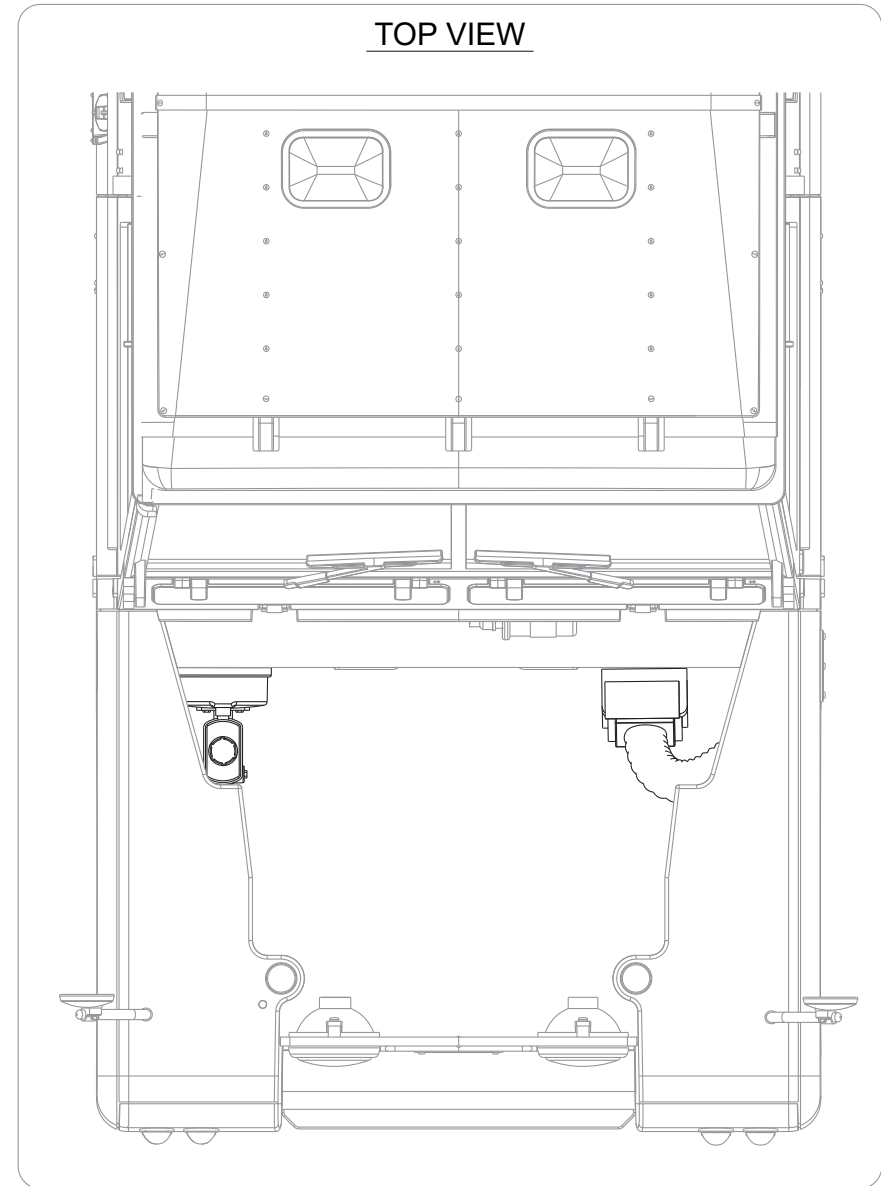

TOP VIEW

# KUDU™ Series Land Rover® Realistic Engine Bay Set (#BRX02378)

Difficulty Level: ★★☆☆☆

13.

Glue the radiator assembly to the front of the main body.

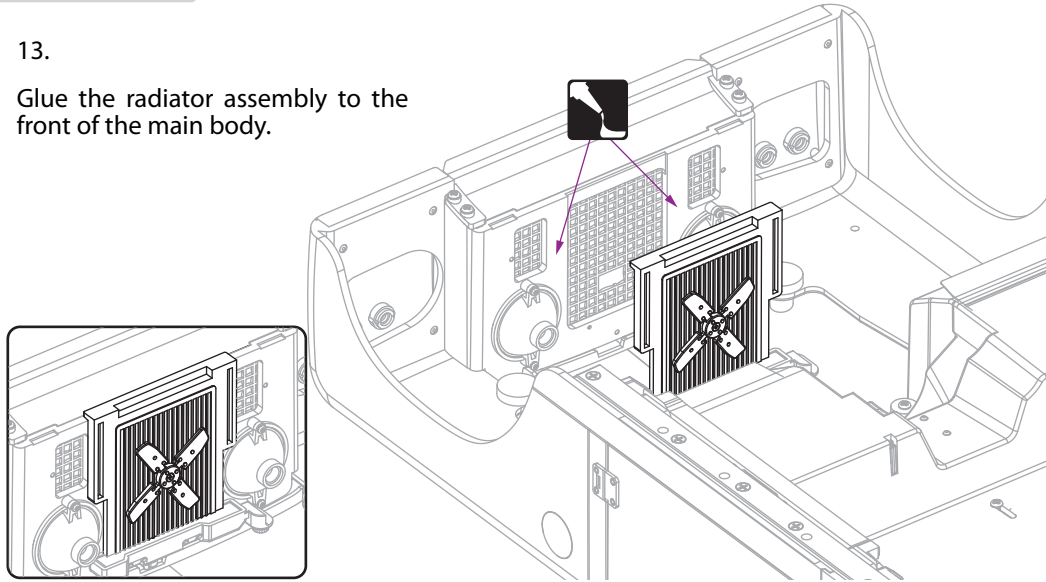

14.

Remove the motor for the next steps (note motor wires must be on the left hand side). Also remove the two screws on the ESC plate.

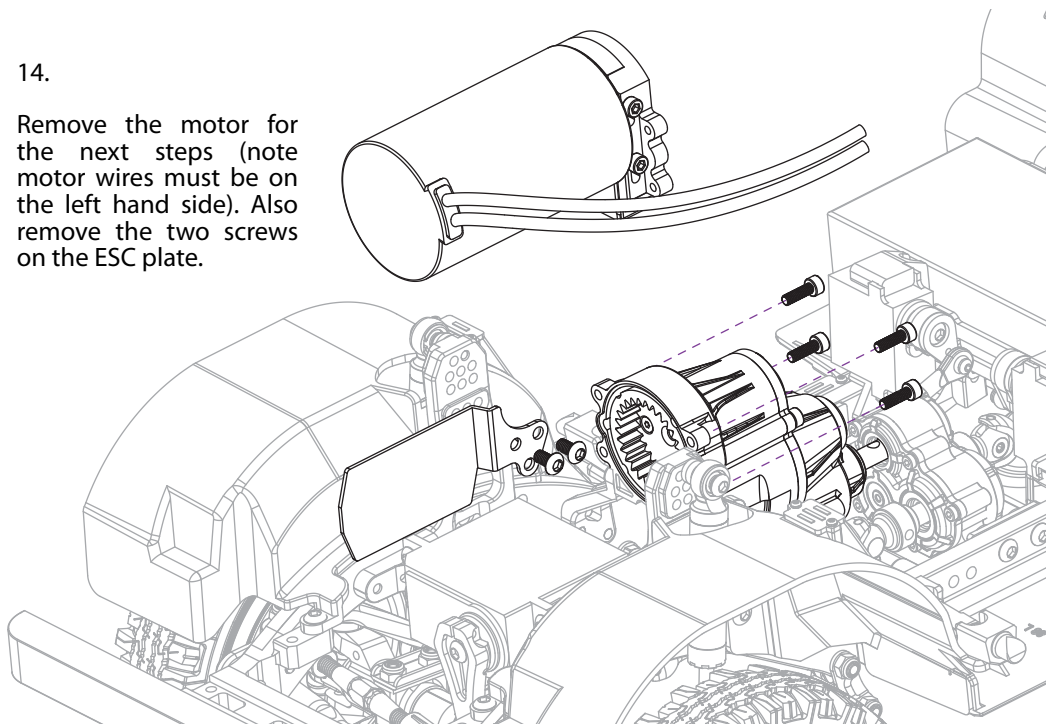

Hole installation for Series Land Rover 88 and 109.

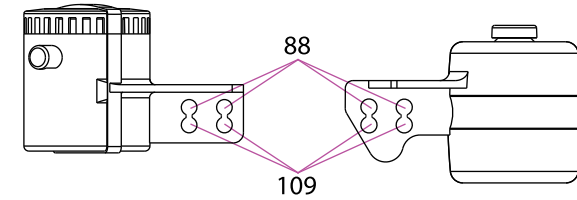

Note: the top holes on the air filter and washer fluid reservoirs are for the 88 chassis and the bottom holes are for the 109 chassis.

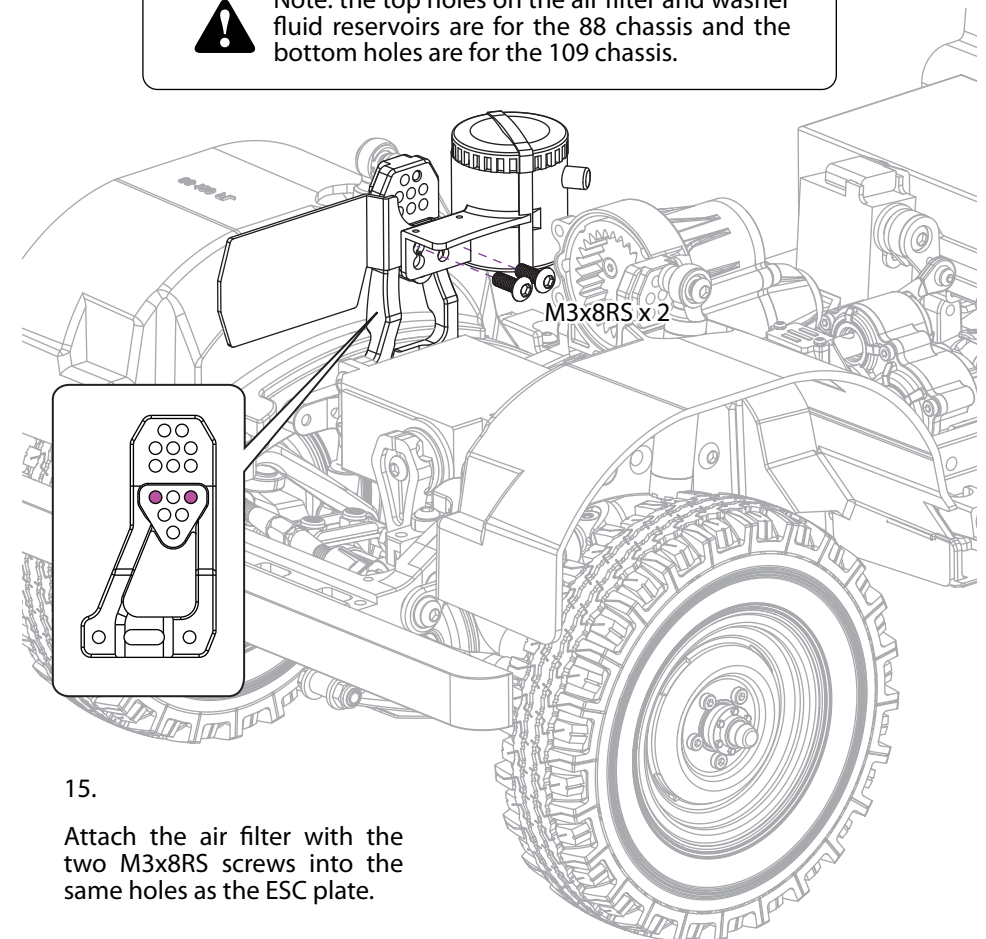

15.

Attach the air filter with the two M3x8RS screws into the same holes as the ESC plate.

# KUDU™ Series Land Rover® Realistic Engine Bay Set (#BRX02378)

Difficulty Level: ★★☆☆☆

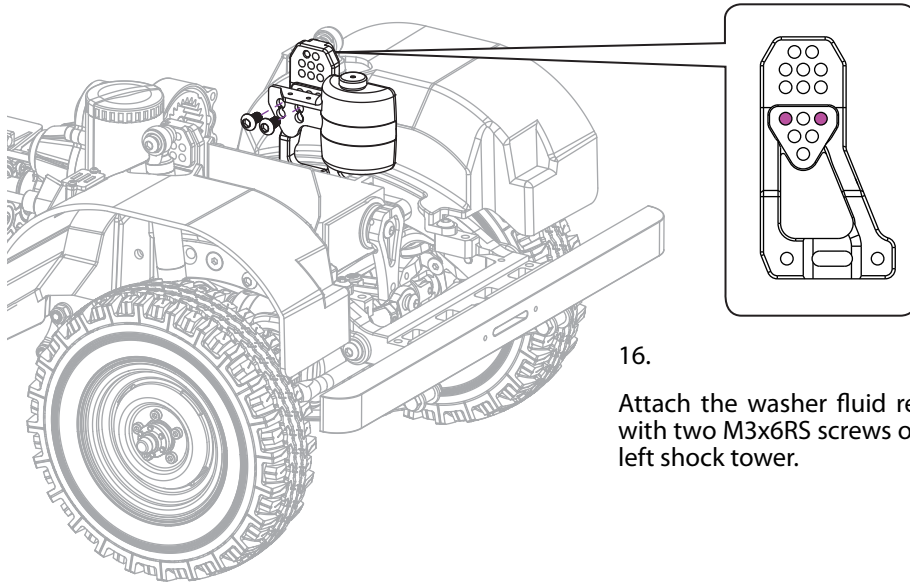

16.  
Attach the washer fluid reservoir with two M3x6RS screws onto the left shock tower.

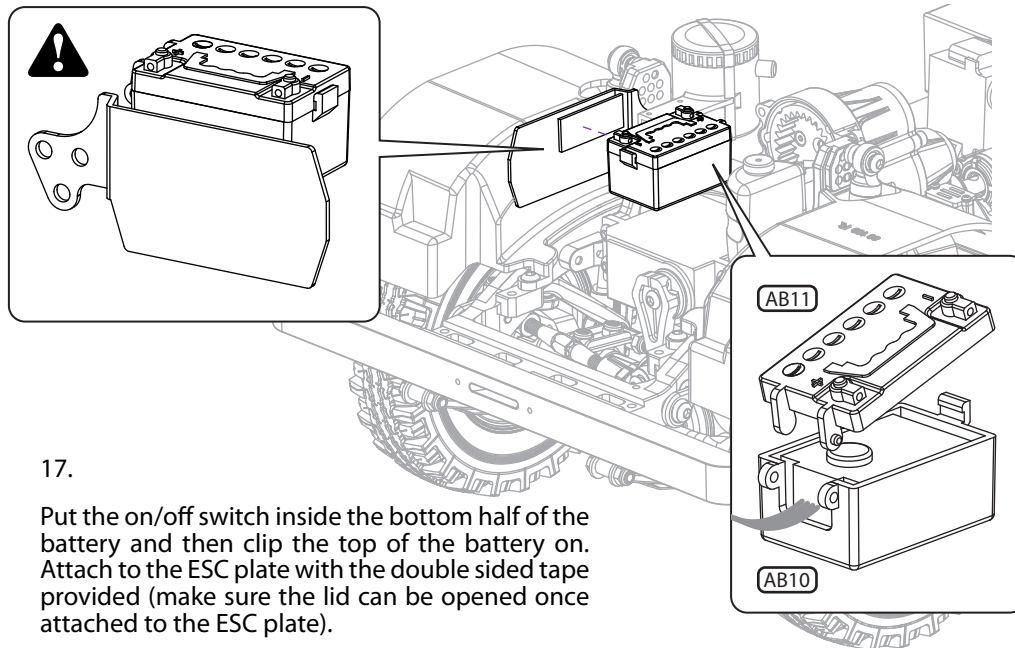

17.  
Put the on/off switch inside the bottom half of the battery and then clip the top of the battery on. Attach to the ESC plate with the double sided tape provided (make sure the lid can be opened once attached to the ESC plate).

18.  
Reinstall the motor to the gearbox.

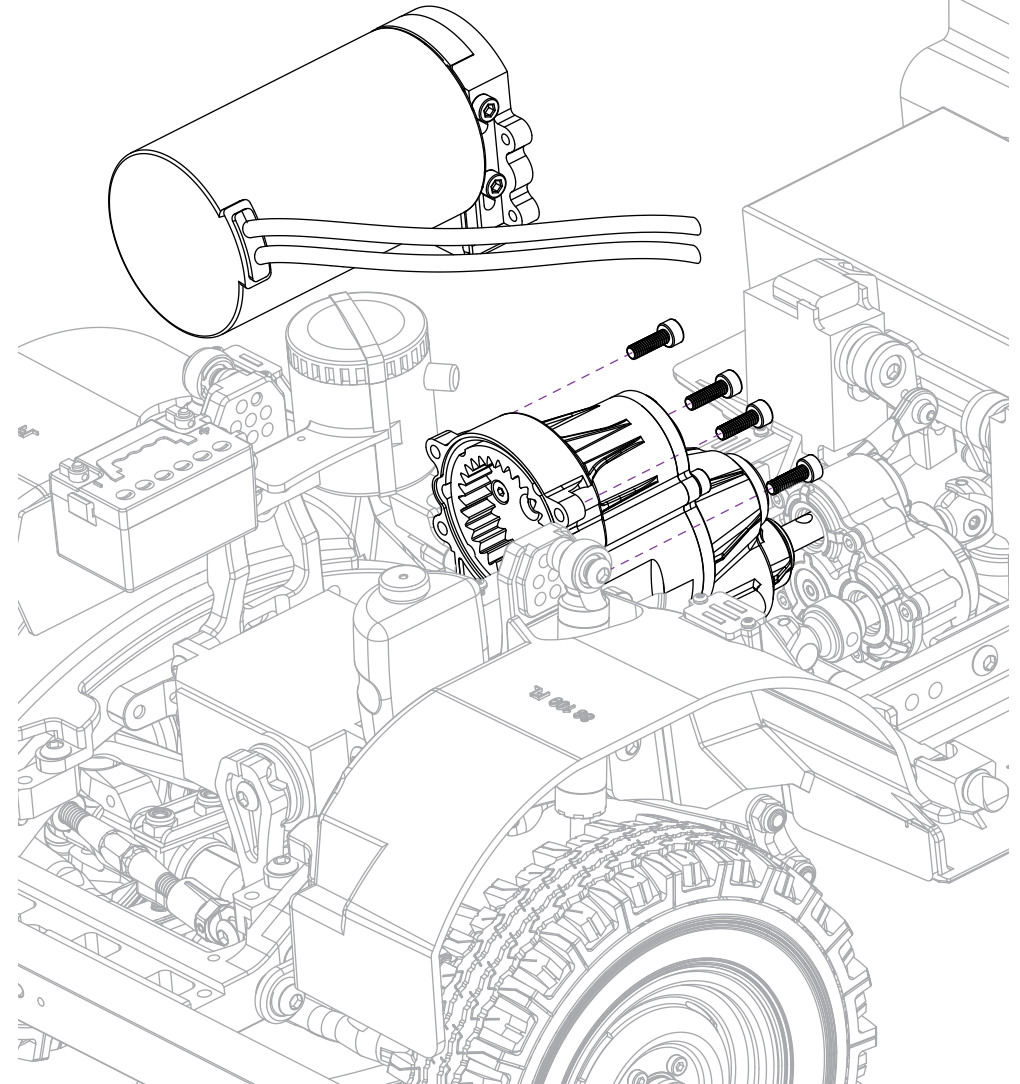

# KUDU™ Series Land Rover® Realistic Engine Bay Set (#BRX02378)

Difficulty Level: ★★☆☆☆

19.

Line up the complete cylinder head and manifold assembly to the four holes on the air filter and washer fluid reservoirs. Attach it with four ST1.7x4CCS screws.

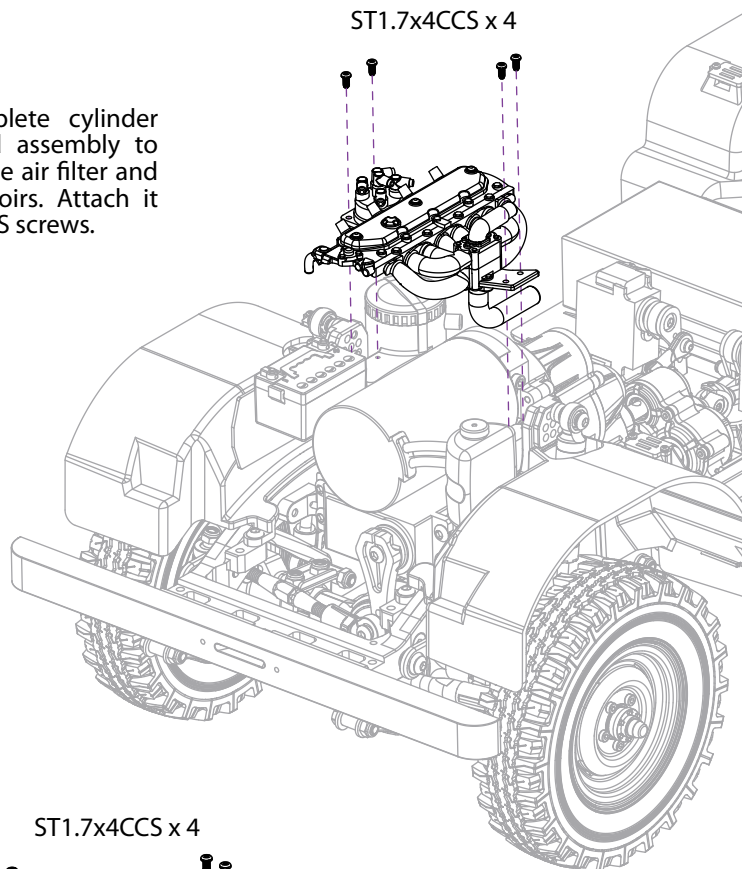

ST1.7x4CCS x 4

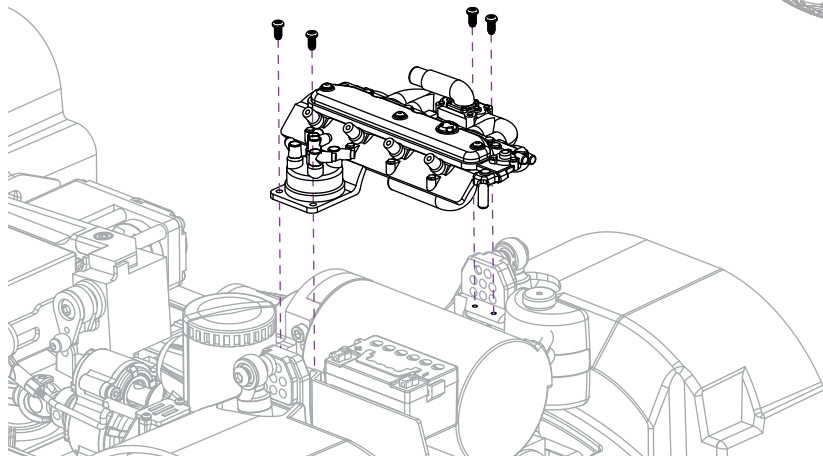

20.

Push the flexible intake hose onto the intake manifold pipe and then onto the air filter.

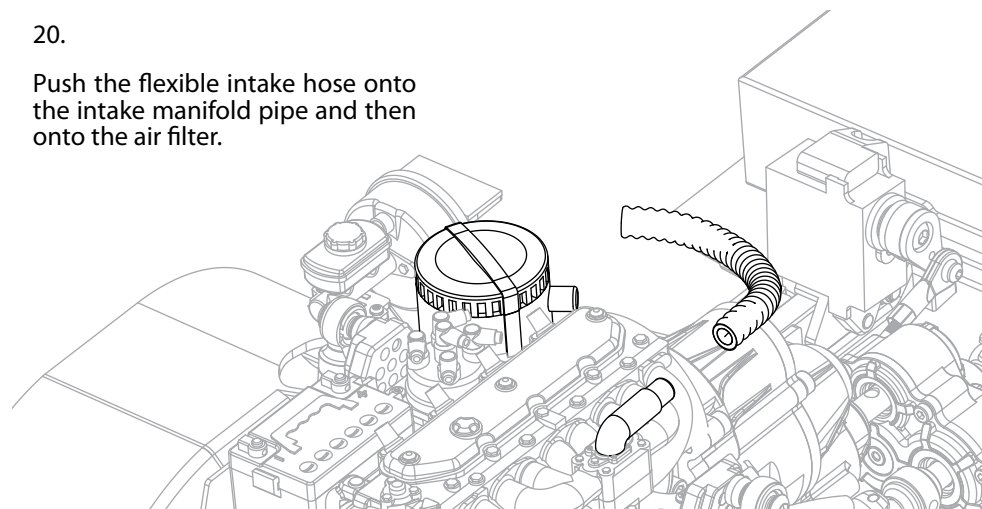

21.

Measure how long you want the spark plug leads and cut them to length. Attach the wire with a dab of glue to the plugs. Do the same with the battery wires and run them wherever you wish. We recommend doing a dry fit first before gluing the wires in place.



**Very important note:**

Unplug the coil plug first before removing the body to avoid damaging the lead.

